

HSC2001

Socket

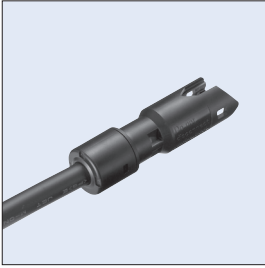

ソケット Socket	適合プラグ Mate Plug
HSC2001	HSC2002 HSC2003

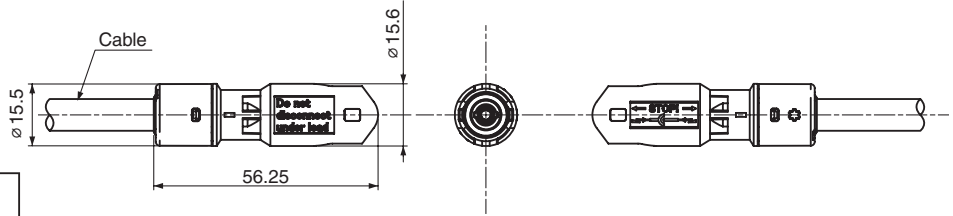

定格電圧 Rated voltage	1000V DC (TÜV) 600V DC (UL)
定格電流 Rated current	30A DC max.
使用温度範囲 Operating temperature	-40°C to +90°C
認証 Certification	TÜV UL

HSC2002

Plug (Half Lock)

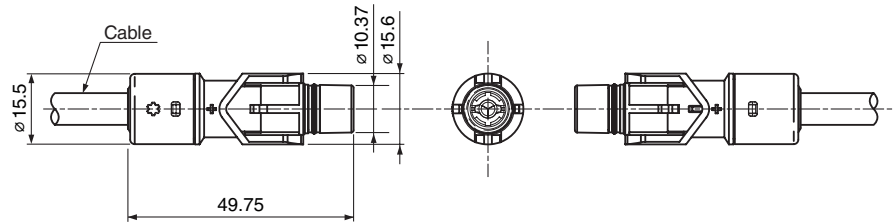
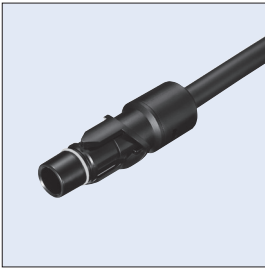

定格電圧 Rated voltage	1000V DC (TÜV)
定格電流 Rated current	30A DC max.
使用温度範囲 Operating temperature	-40°C to +90°C
認証 Certification	TÜV

HSC2003

Plug (Full Lock)

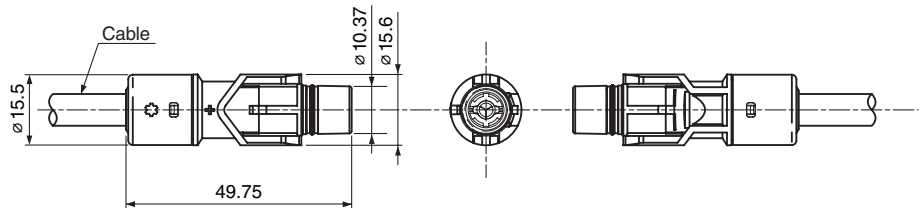

定格電圧 Rated voltage	1000V DC (TÜV) 600V DC (UL)
定格電流 Rated current	30A DC max.
使用温度範囲 Operating temperature	-40°C to +90°C
認証 Certification	TÜV UL

HSC2009

Plug



定格電圧 Rated voltage	1000V DC (TÜV) 600V DC (UL)
定格電流 Rated current	30A DC max.
使用温度範囲 Operating temperature	-40°C to +90°C
認証 Certification	TÜV UL

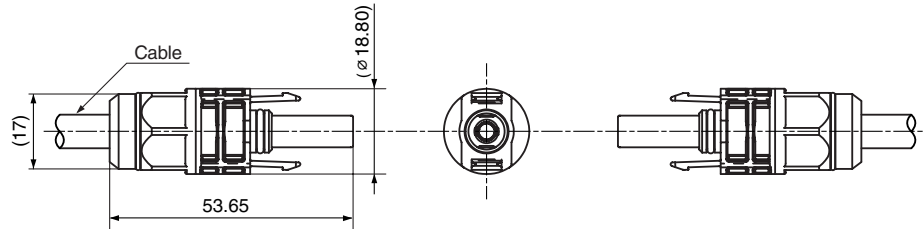

プラグ Plug	適合ソケット Mate Socket
HSC2009	HSC2010 HSC2012

HSC2010

Socket (Half Lock)



定格電圧 Rated voltage	1000V DC (TÜV) 600V DC (UL)
定格電流 Rated current	30A DC max.
使用温度範囲 Operating temperature	-40°C to +90°C
認証 Certification	TÜV UL

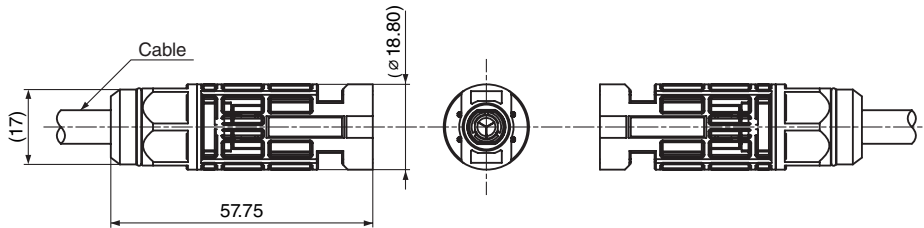

HSC2012

Socket (Full Lock)



定格電圧 Rated voltage	1000V DC (TÜV) 600V DC (UL)
定格電流 Rated current	30A DC max.
使用温度範囲 Operating temperature	-40°C to +90°C
認証 Certification	TÜV UL

